

160 Amp - Mini MIG Guns

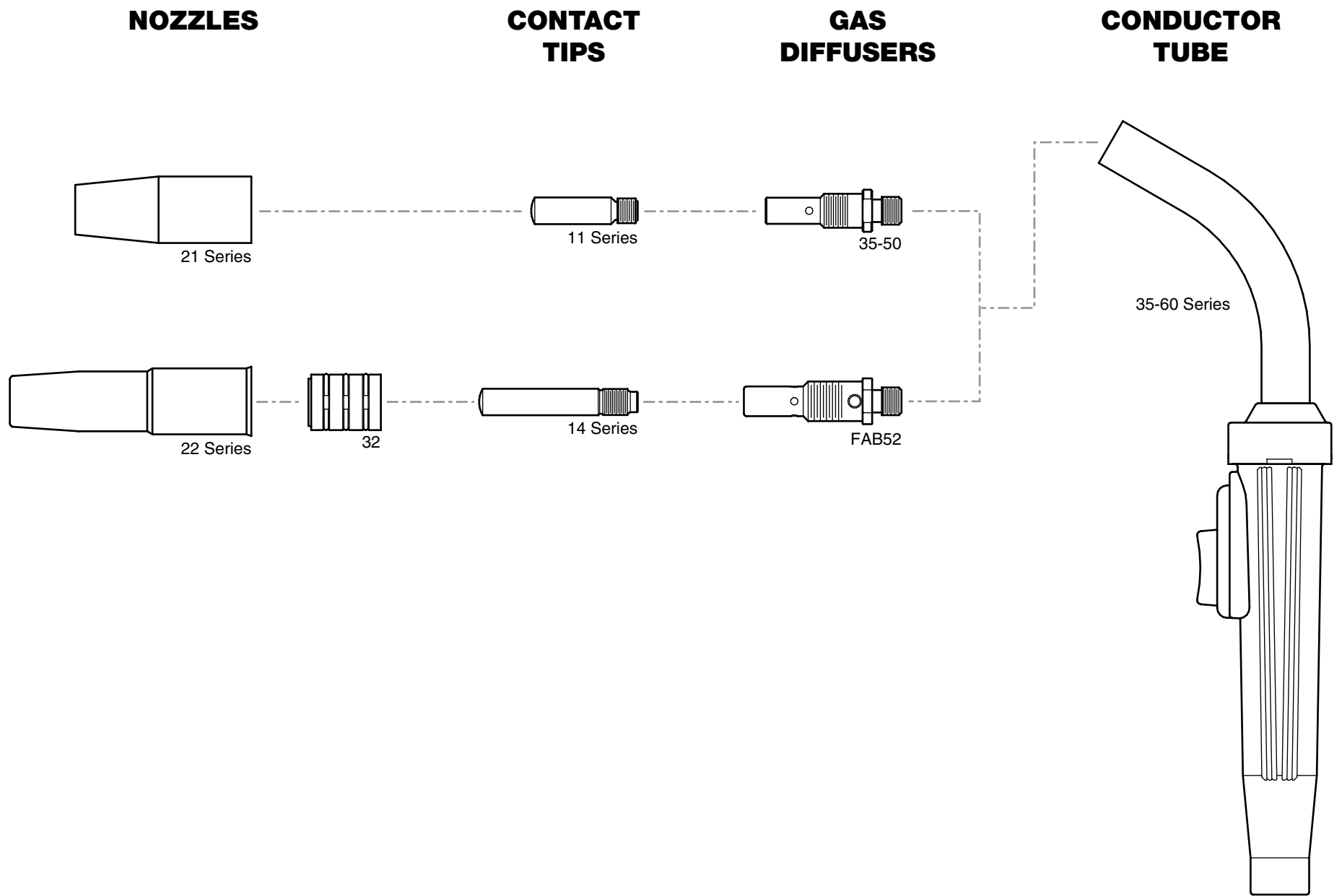

Nozzle Style	Bore Diameter (in/mm)	Part No.	Stock No.	Nozzle/Contact Tip Relationship	Gas Diffuser		Conductor Tube	
					Part No.	Stock No.	Part No.	Stock No.
Thread-On	3/8" (9,5mm)	21-37F	1210-1102	Tip Flush	35-50 (1)	1500-1100	35-60-45 35-60-60 35-60-80 3560SFLX480	1600-1101 1600-1102 1600-1103 1600-1141
	3/8" (9,5mm)	21-37	1210-1100	1/8" (3,2mm) Tip Recess				
	3/8" (9,5mm)	21T-37	1210-1300	Tapered 1/8" (3,2mm) Tip Recess				
	3/8" (9,5mm)	21T-37F	1210-1302	Tapered Tip Flush				
	1/2" (12,7mm)	21-50F	1210-1112	Tip Flush				
	1/2" (12,7mm)	21-50	1210-1110	1/8" (3,2mm) Tip Recess				
	5/8" (15,9mm)	21-62F	1210-1122	Tip Flush				
	5/8" (15,9mm)	21-62	1210-1120	1/8" (3,2mm) Tip Recess				
Slip-On (A)	3/8" (9,5mm)	22-37SS	1220-1101	Short Stop 1/8" (3,2mm) Tip Recess	FAB52 (2)	1520-1120	35-60-45 35-60-60 35-60-80 3560SFLX480	1600-1101 1600-1102 1600-1103 1600-1141
	3/8" (9,5mm)	22T-37SS	1220-1301	Tapered - Short Stop 1/8" (3,2mm) Tip Recess				
	1/2" (12,7mm)	22-50	1220-1110	Adjustable Recess to Projection				
	1/2" (12,7mm)	22-50SS	1220-1121	Short Stop 1/8" (3,2mm) Tip Recess				
	5/8" (15,9mm)	22-62	1220-1120	Adjustable Recess to Projection				
	5/8" (15,9mm)	22-62SS	1220-1121	Short Stop 1/8" (3,2mm) Tip Recess				

NOTE: Slip-On (A) nozzles requires a nozzle insulator – Part No. 32 (Stock No. 1320-1100)
 The (#) after the Gas Diffuser Part No. indicates the series of Contact Tip that can be used with the particular diffuser. Refer to Contact Tip Chart – column "Gas Diffuser"

Contact Tips

Wire Size in/mm	Tip I.D. in/mm +/- .003" (0,08mm)	Part No.	Stock No.	Part No.	Stock No.	Part No.	Stock No.	Part No.	Stock No.	Gas Diffuser
.023" (0,6mm)	.031" (0,79mm)	11-23	1110-1100			11T-23	1110-1300			(1)
.030" (0,8mm)	.038" (0,97mm)	11-30	1110-1101	11H-30	1110-1201	11T-30	1110-1301			
.035" (0,9mm)	.044" (1,12mm)	11-35	1110-1102	11H-35	1110-1202	11T-35	1110-1302	11RS-35	1110-1225	
.040" (1,0mm)	.048" (1,22mm)	11-40	1110-1103	11H-40	1110-1203	11T-40	1110-1303			
.045" (1,2mm)	.054" (1,37mm)	11-45	1110-1104	11H-45	1110-1204	11T-45	1110-1304	11RS-45	1110-1226	
3/64"AL (1,2mm)	.059" (1,50mm)			11AH-364	1110-1213					
.023" (0,6mm)	.031" (0,79mm)	14-23	1140-1100			14T-23	1140-1300			(2)
.030" (0,8mm)	.038" (0,97mm)	14-30	1140-1101			14T-30	1140-1301			
.035" (0,9mm)	.044" (1,12mm)	14-35	1140-1102	14H-35	1140-1202	14T-35	1140-1302			
.040" (1,0mm)	.048" (1,22mm)	14-40	1140-1103	14H-40	1140-1203	14T-40	1140-1303			
.045" (1,2mm)	.054" (1,37mm)	14-45	1140-1104	14H-45	1140-1204	14T-45	1140-1304			
.052" (1,3mm)	.064" (1,65mm)	14-52	1140-1105	14H-52	1140-1205	14T-52	1140-1305			
1/16" (1,6mm)	.073" (1,85mm)	14-116	1140-1106	14H-116	1140-1206	14T-116	1140-1306			
5/64" (2,0mm)	.090" (2,29mm)	14-564	1140-1109	14H-564	1140-1209					
3/64"AL (1,2mm)	.059" (1,50mm)	14A-364	1140-1113	14AH-364	1140-1213					
1/16"AL (1,6mm)	.082" (2,08mm)			14AH-116	1140-1214					

Conduit Liners

Wire Size	15 ft. (5M)		25 ft. (8M)	
	Part No.	Stock No.	Part No.	Stock No.
.023" (0,6mm)	23-40-15	1400-1123		
.030" (0,8mm) - .035" (0,9mm)	35-40-15	1400-1133	35-40-20	1400-1134
.040" (1,0mm) - .045" (1,2mm)	45-40-15	1400-1143	45-40-20	1400-1144
.030" (0,8mm) - .035" (0,9mm) AL	35TF-40-10	1400-1031		
.040" (1,0mm) - 3/64" (1,2mm) AL	45TF-40-10	1400-1041		

Note: Aluminum wire conduit not recommended for lengths over 10ft. (3M)
 AL – Aluminum