

SURELOK™ PCH/M-62 RPT Torch

Ordering Information

A SureLok Replacement Torch installation requires a torch/leads, a power supply adapter kit, and a torch spare parts kit. The model of the Plasma Cutting system must be known to determine the adapter kit required. Select the torch configuration and lead length, an adapter kit for applicable power source, and spare parts kit from the information below to complete the installation

Torch And Leads Combinations

40 Amps PCH-62 Hand		40 Amps PCM-62 Mach (Fiberglass Tube w/ rack)	
Cat.No.	Description	Cat.No.	Description
7-6220	PCH-62, 70°, 20' (6.1m) Torch/Leads	7-6224	PCM-62, 180°, 25' (7.6m) Torch/Leads
7-6221	PCH-62, 70°, 50' (15.2m) Torch/Leads	7-6225	PCM-62, 180°, 50' (15.2m) Torch/Leads
7-6222	PCH-62, 90°, 20' (6.1m) Torch/Leads		
7-6223	PCH-62, 90°, 50' (15.2m) Torch/Leads		

Note: See Adapter Kit Selection for Mechanized Torch Remote Interface kit (required if using CNC cable or Remote Pendant (7-3114) control via torch/unit connection)

Torch Spare Parts Kits

5-6204	Up to 40 Amps (All TDC, other Manufacturers)		
--------	--	--	--

PCH/M-62 Torch RPT

Replacement Torch Parts

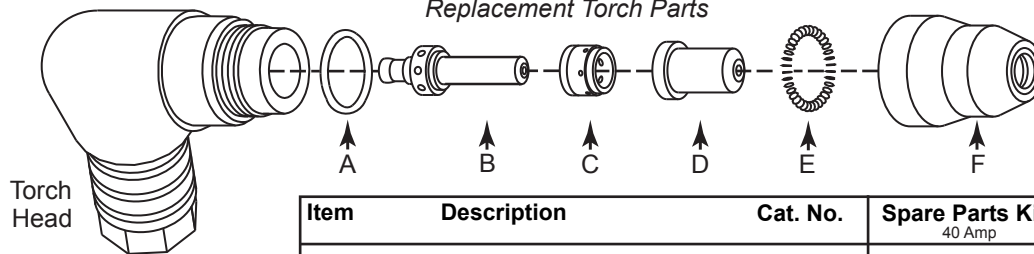

× Included in all RPT torches.

Item	Description	Cat. No.	Spare Parts Kits 40 Amp
A	O-Ring	8-0532	1
B	× Electrode, Air/N2, General Purpose	9-8402	5
B	Electrode, Air/N2, MaximumLife™	9-8407	
C	Gas Distributor, Cutting	9-8401	1
D	Tip, Cutting, 40 Amp, Drag	9-8411	5
D	Tip, Cutting, 40 Amp, Standoff	9-8412	
D	Tip, Gouging, 40 Amp	9-8416	
E	Coil Spring	9-7501	
F	Shield Cup	9-8400	1
N/S	Stand-Off Cutting Guide	9-8415	1
	PCH-62 70° Torch Head	9-8410	
	PCH-62 90° Torch Head	9-8409	
	PCM-62 180° Torch Head	9-8408	

Some of the Parts have

SURELOK™

Technology Patents Pending