

### PLASMA TORCHES AND CONSUMABLES

#### PCH/M-51 Pak 5XR, Pak 625XR

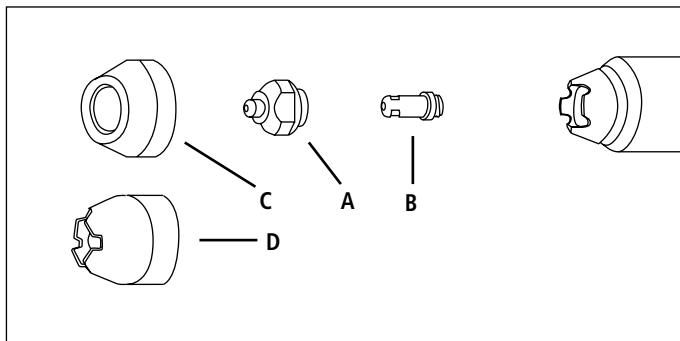

#### PCH/M-51 Consumables:

ITEM	DESCRIPTION	PART No.
A	Tip - Gouging	OTD9/5724
A	Tip 10-40 amp Air	OTD9/5718*
A	Tip 10-60 amp Air	OTD9/5631
A	Tip 65 amp Air	OTD8/3321*
B	Electrode	OTD9/5633
B	Electrode	OTD9/5720*
C	Shield Cup Ceramic	OTD9/5630
C	Shield Cup - Vespel - Long	OTD8/2151*
C	Shield Cup - Vespel - Std	OTD8/2152*
C	Shield Cup - Phenolic - Std	OTD8/2159
D	Shield Cup-Crown (fits over OTD8/2159)	OTD9/5779*
D	Shield Cup - Crown Ceramic	OTD8/5526

#### Plasma Torch Spare Parts

Torch Head 70°	OTD9/5635
Torch Head 180°	OTD9/5634
PCH-51 Torch 70° (7.6M)	OTD2/2860

\* Represents Part Numbers no longer available from CIGWELD and represents reference data only.

#### PCH/M-52 for Pak 625XR, Pak 1250XR, Pak 10XR

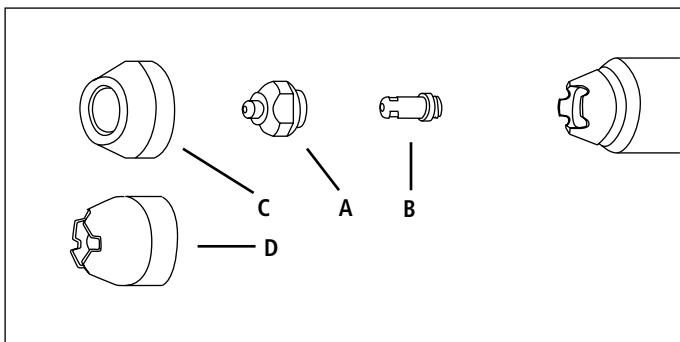

#### PCH/M-52 Consumables:

ITEM	DESCRIPTION	PART No.
A	Tip 35 amp Air	OTD9/5702
A	Tip 45-55 amp Air	OTD9/5618*
A	Tip 60-70 amp Air	OTD9/5707
A	Tip 80 amp Air	OTD9/5782*
A	Tip 105 amp Air	OTD9/5708
A	Tip Gouging	OTD8/5129*
A	Tip, Gouging 70 amp .078	OTD9/5709*
A	Tip, Gouging 105 amp .093	OTD9/5710
A	Tip, Gouging 105 amp .113	OTD9/5713
B	Electrode-Air	OTD8/3331*
B	Electrode-Air (Plated)	OTD9/5619
B	Electrode-Multi-Gas	OTD9/5711
C	Shield Cup - Crown Ceramic	OTD9/5694
C	Shield Cup - Drag - Vespel	OTD8/5712*
C	Shield Cup - Gouging Ceramic	OTD9/5128*
C	Shield Cup - Phenolic-Std	OTD9/5781
C	Shield Cup - Std Ceramic	OTD9/5617
D	Shield Cup-Crown (fits over OTD9/5781)	OTD9/5780*

#### Plasma Torch Spare Parts

Torch Head 70°	OTD9/5642
Torch Head 180°	OTD9/5643
PCH-52 Torch 70° (7.6M)	OTD2/2936

\* Represents Part Numbers no longer available from CIGWELD and represents reference data only.

#### PCH/M-60 PakMaster™ 75XL Plus (Pre January 2001)

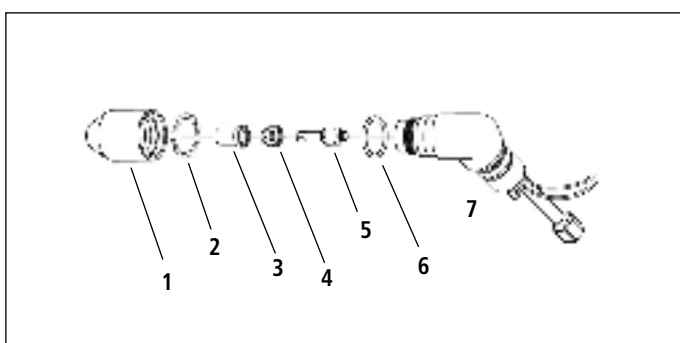

#### PCH/M-60 Consumables:

ITEM	DESCRIPTION	PART No.
1	Shield Cup	OTD8/7500
1	Shield Cup Crown	OTD8/7507
2	Coil Spring	OTD9/7501
3	Tip, Cutting, 60 amp, Air/N2	OTD9/7726
3	Tip, Cutting 35 amp, Drag	OTD8/7503
3	Tip, Gouging	OTD8/7506
4	Gas Distributor, Cutting	OTD8/7501
4	Gas Distributor, Gouging	OTD8/7508
5	Electrode, Air/N2	OTD8/7502
6	O-Ring	OTD8/0532

#### Plasma Torch Spare Parts

Torch Head 70°	OTD9/8075*
PCH-60 Torch 70° (7.6M)	OTD2/6660*

\* Represents Part Numbers no longer available from CIGWELD and represents reference data only.