

“CT” Series Nozzles For TAM and RA Series MIG Gun and Cable Assembly

Standard Features:

- Two-piece nozzle design, consisting of nozzle housing and nozzle insulator housing.
- The nozzle housing is machined from a solid copper alloy bar that assures consistent dimensional stability and an efficient dissipation of heat.
- The nozzle insulator is made up of three (3) component parts:
 - Nozzle Insulator Housing — made from a copper alloy tubing, which is cut to length and formed to size.
 - Nozzle Insert — made from a solid brass alloy with internal threads allowing the nozzle assembly to be threaded onto the conductor tube.
 - Nozzle Insulator — made from G7 silicone material and provides the insulation needed from the conductor tube and nozzle housing.
- The nozzle insulator threads onto the torch body or conductor tube assembly. The nozzle housing is threaded onto the nozzle insulator.
- Nozzle Housing and Nozzle Insulator are ordered separately.

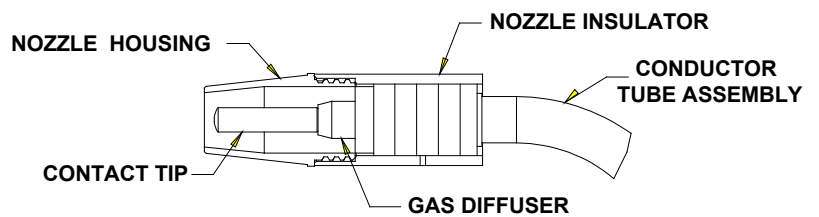

400 Amp Threaded Nozzle

24CT Series Nozzle — Use with 34CT (Stock No. 1340-1400) Nozzle Insulator

24CT Series Nozzle – 1/8” (3,2mm) Tip Recess

Bore Size “A”	Part No.	Stock No.
.375”-9,5mm	24CT-37-S	1240-1404
.500”-12,7mm	24CT-50-S	1240-1414
.625”-15,9mm	24CT-62-S	1240-1424
.750”-19,1mm	24CT-75-S	1240-1434

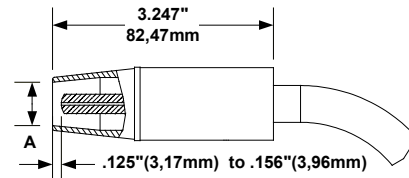

24CT Series Nozzle – Tip Flush

Bore Size “A”	Part No.	Stock No.
.500”-12,7mm	24CT-50-F	1240-1412
.625”-15,9mm	24CT-62-F	1240-1422

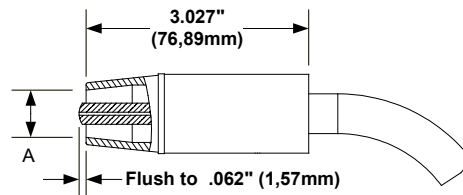

24CT Series Nozzle – 1/2”(12,7mm) Tip Recess

Bore Size “A”	Part No.	Stock No.
.625”-15,9mm	24CT-62-R	1240-1423
.750”-19,1mm	24CT-75-R	1240-1433

